

Primary 1 Lesson 42 "I Belong to the Church of Jesus Christ of Latter-day Saints"

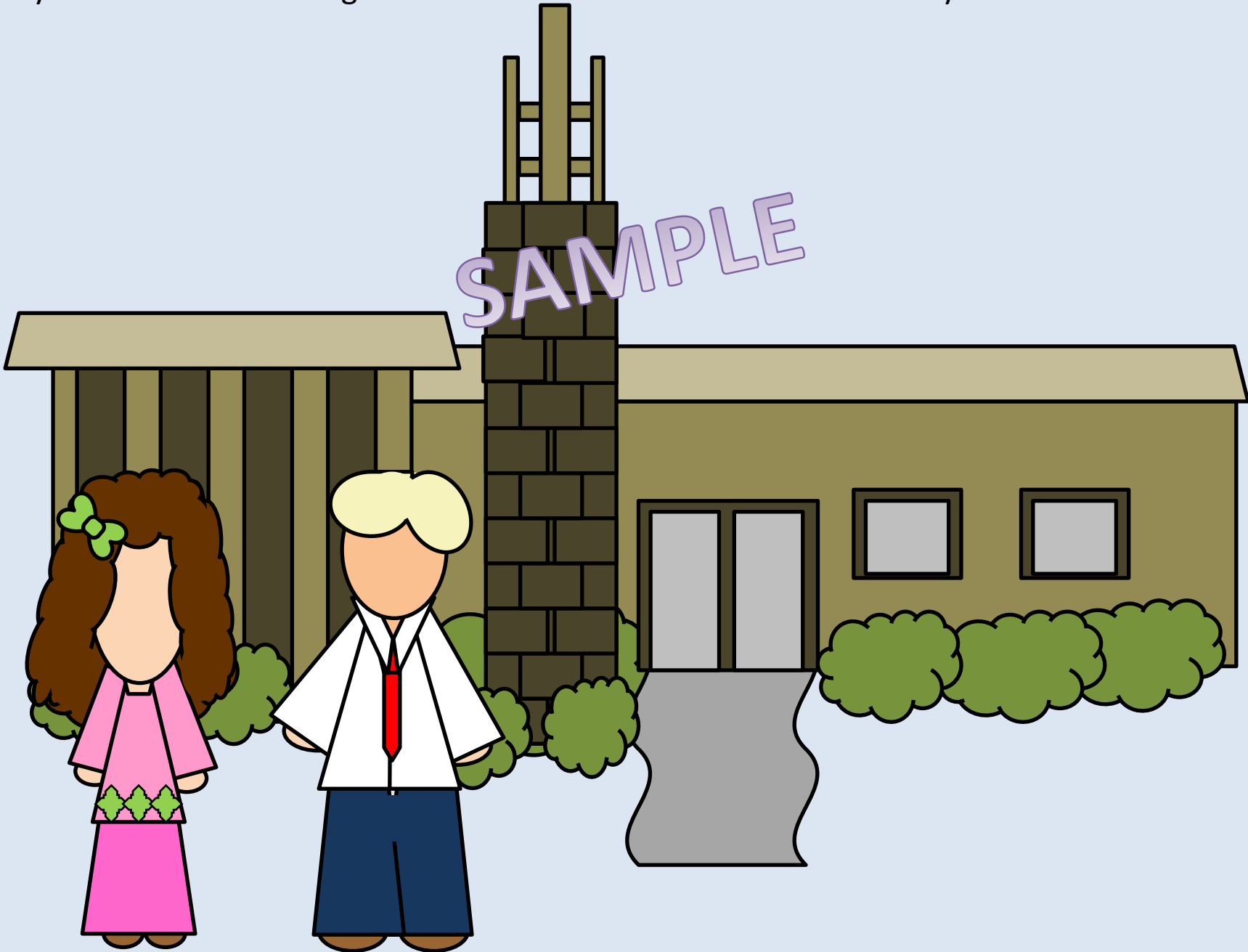

"I Belong to the Church of Jesus Christ of Latter-day Saints"

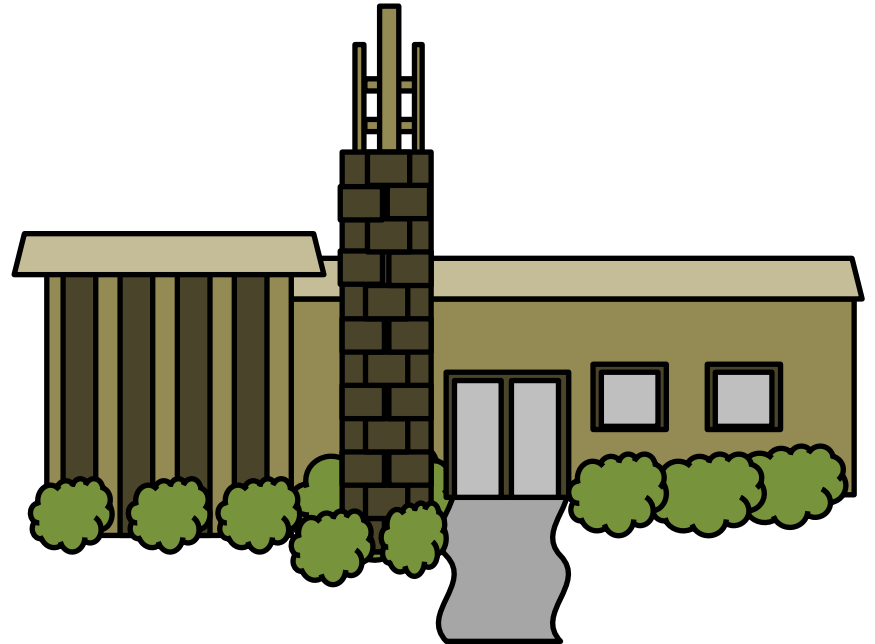
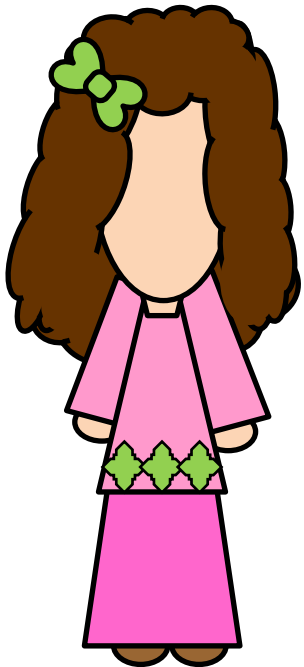
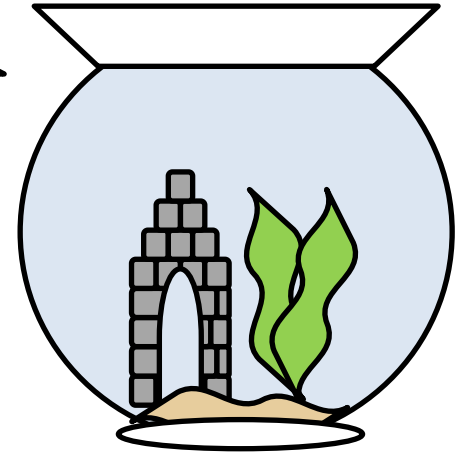
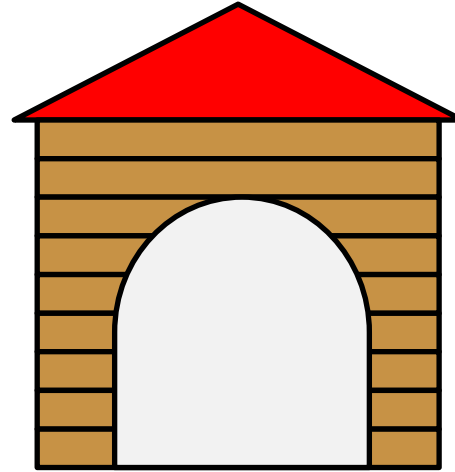
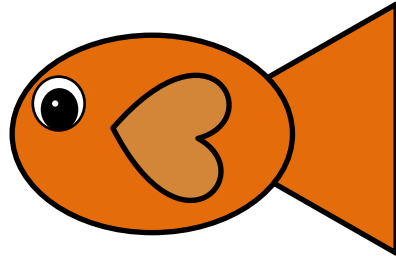
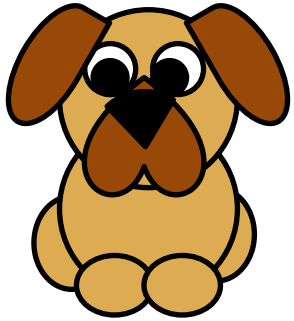

"I Belong to the Church of Jesus Christ of Latter-day Saints"

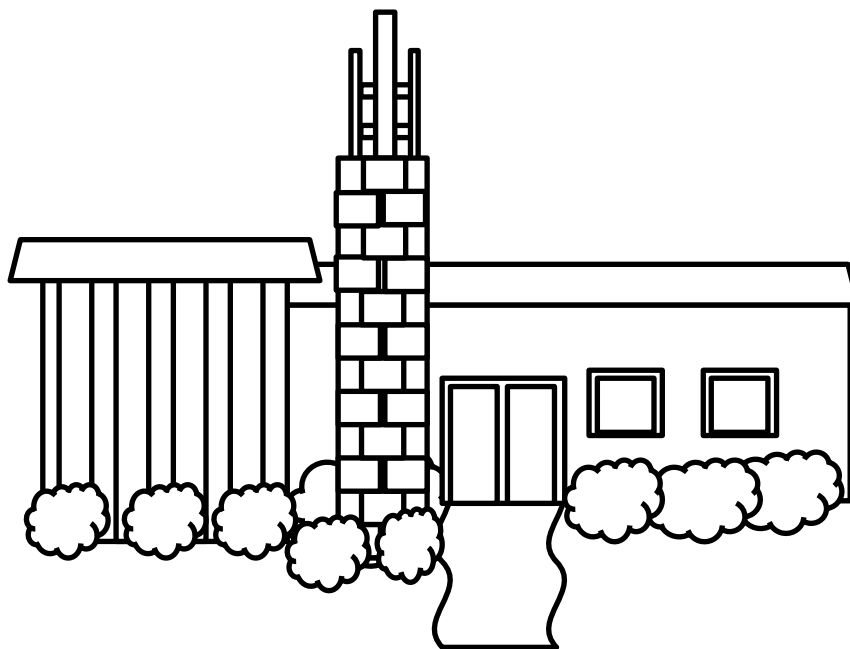
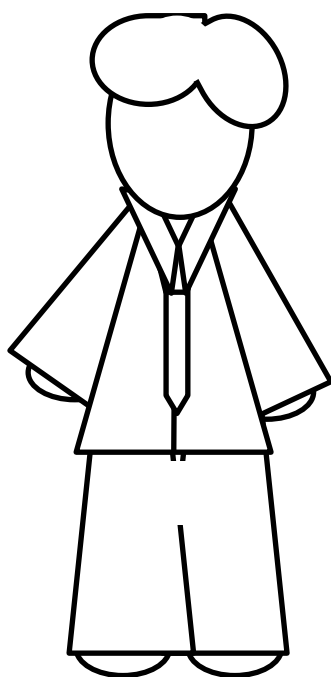
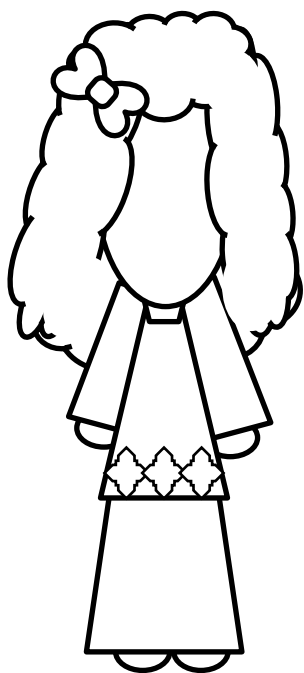
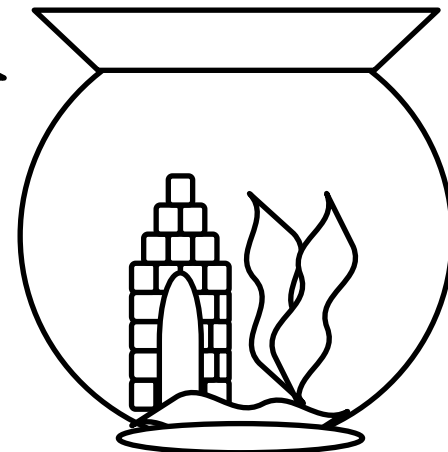
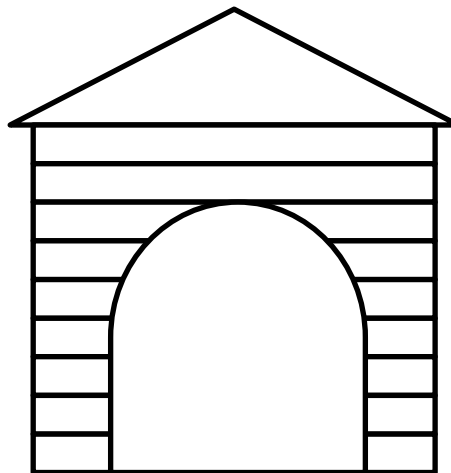
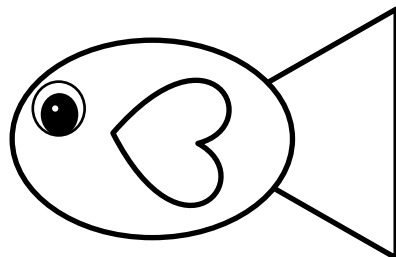
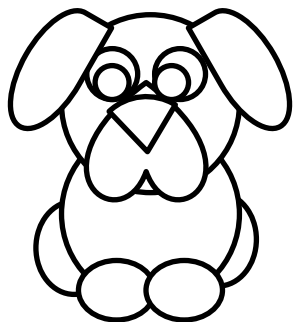

Copy and cut

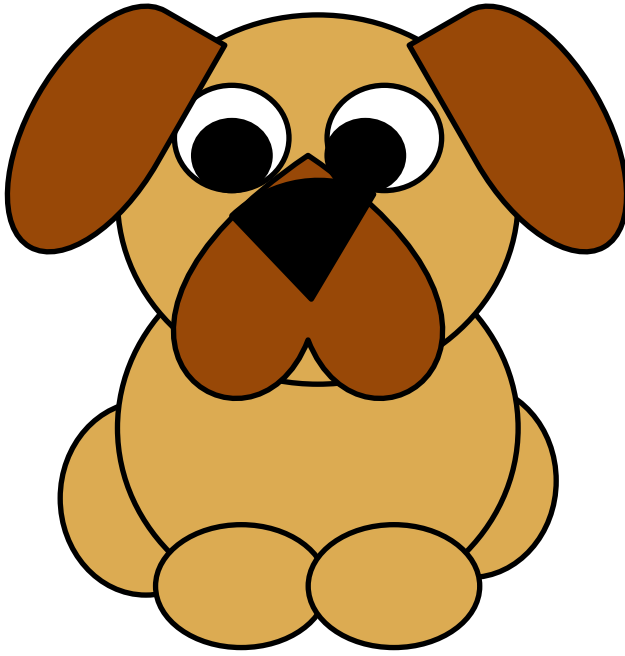
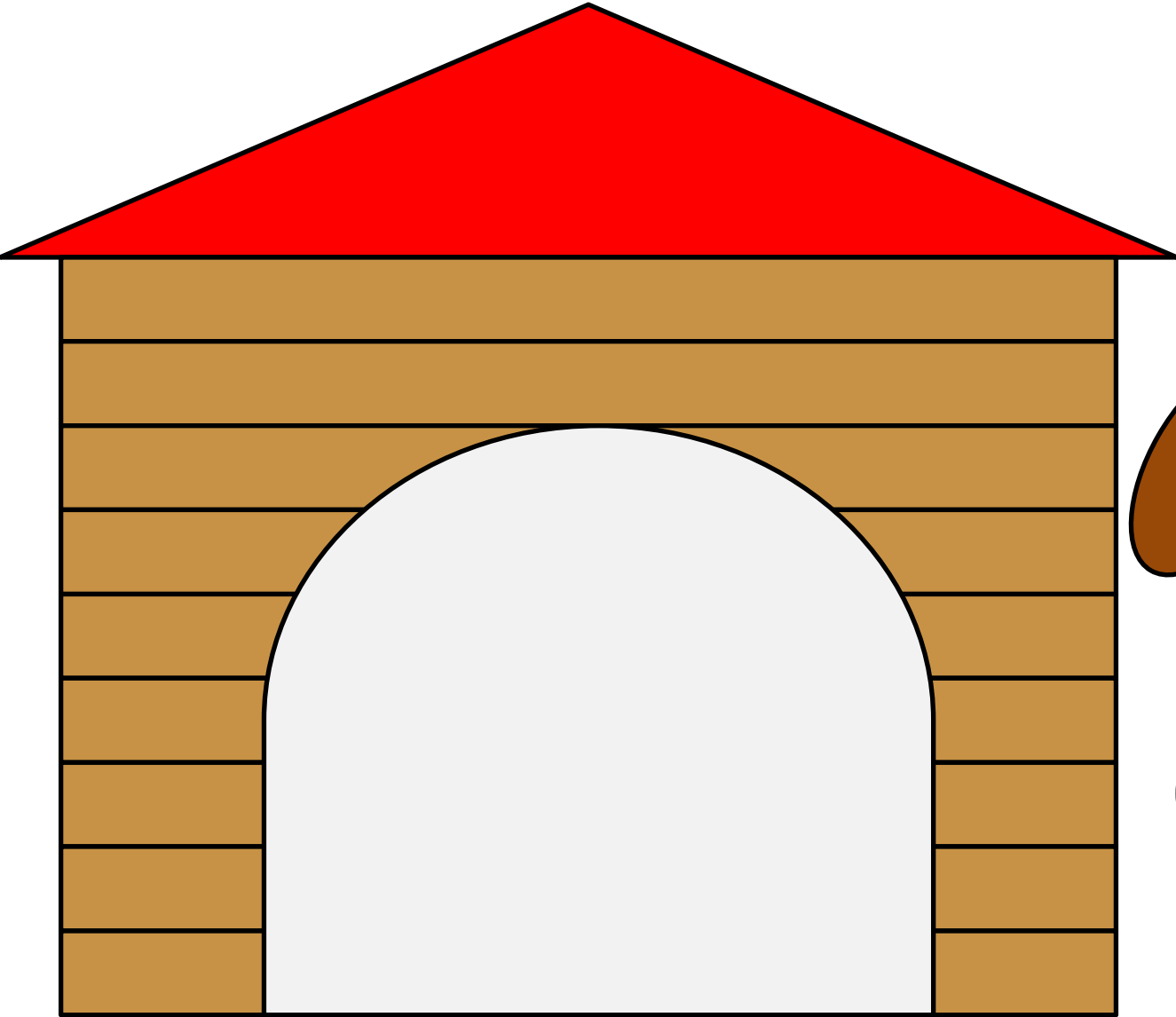

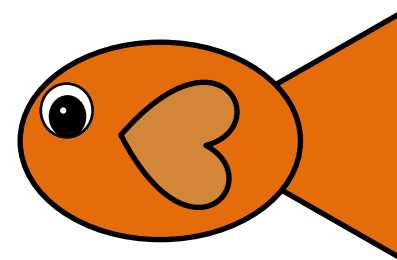
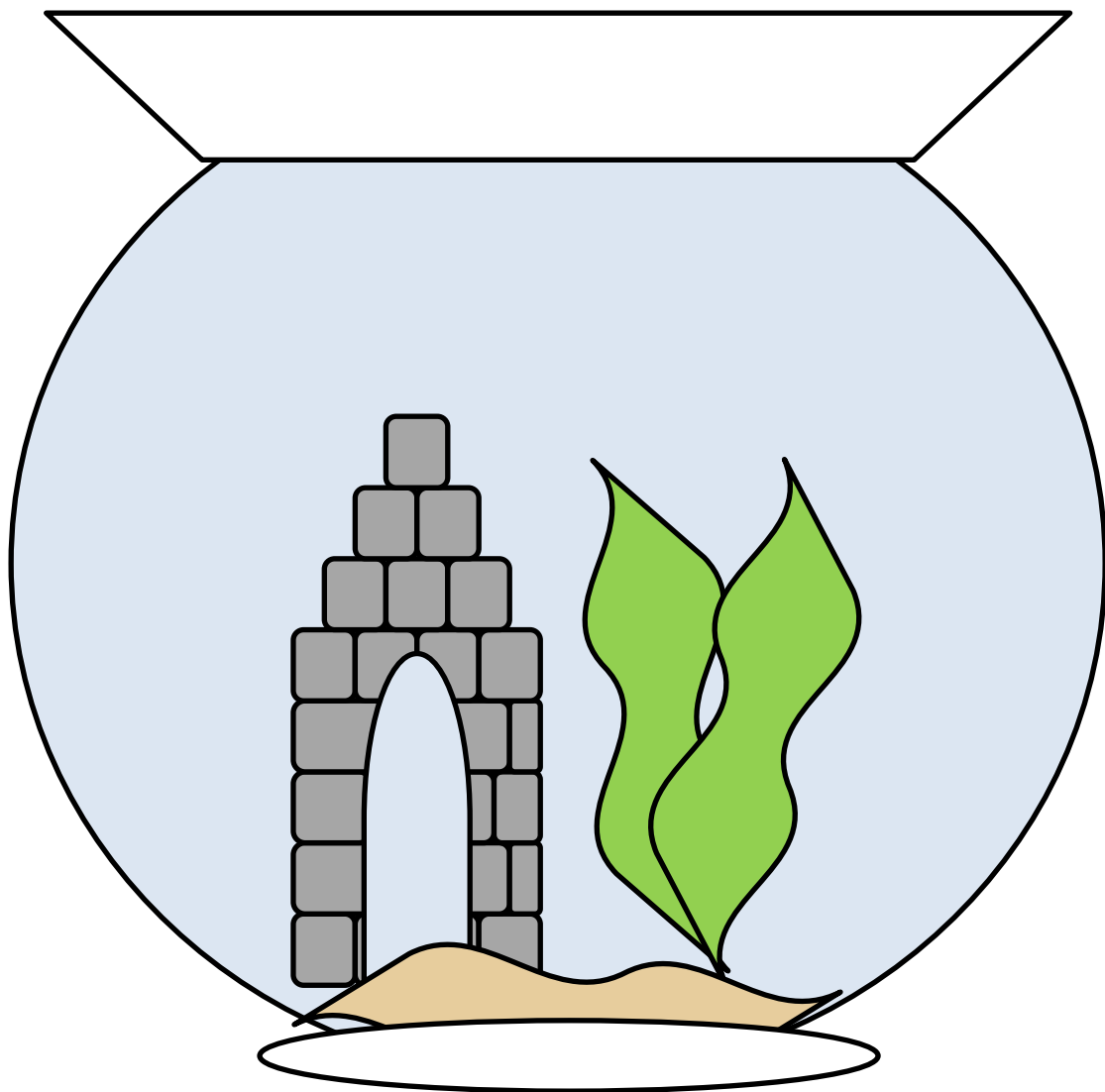

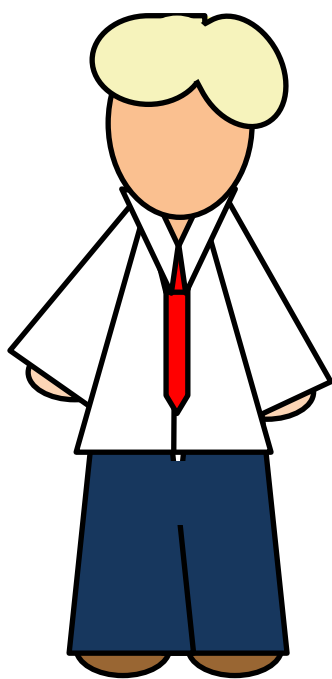
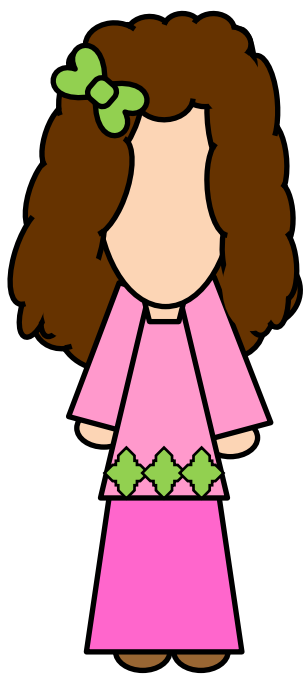

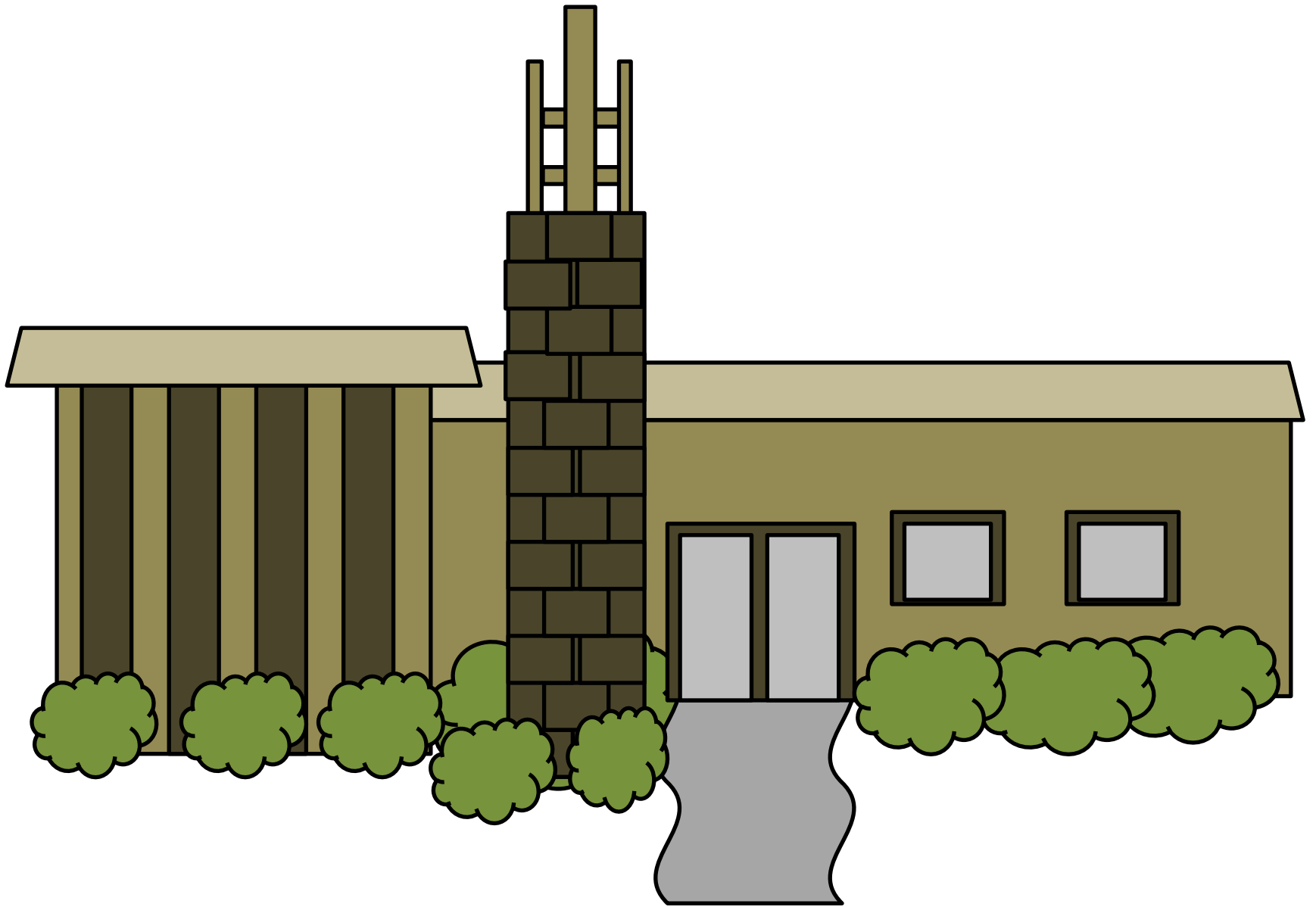

Copy and cut

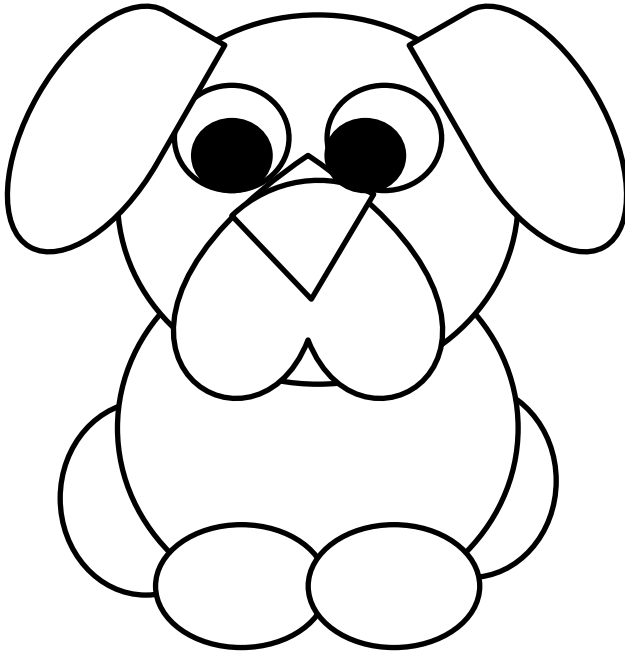
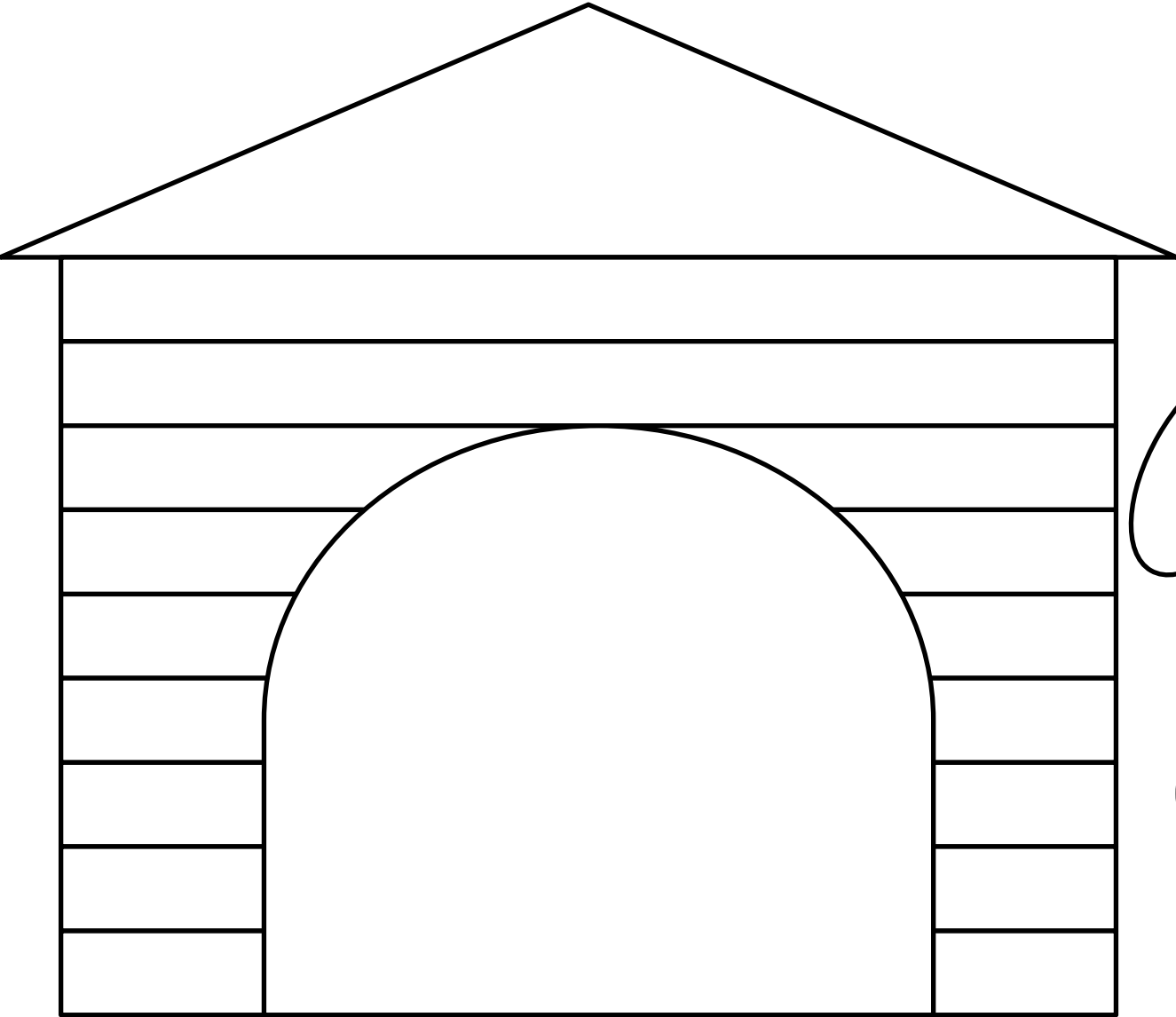



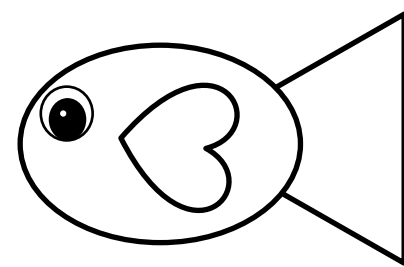
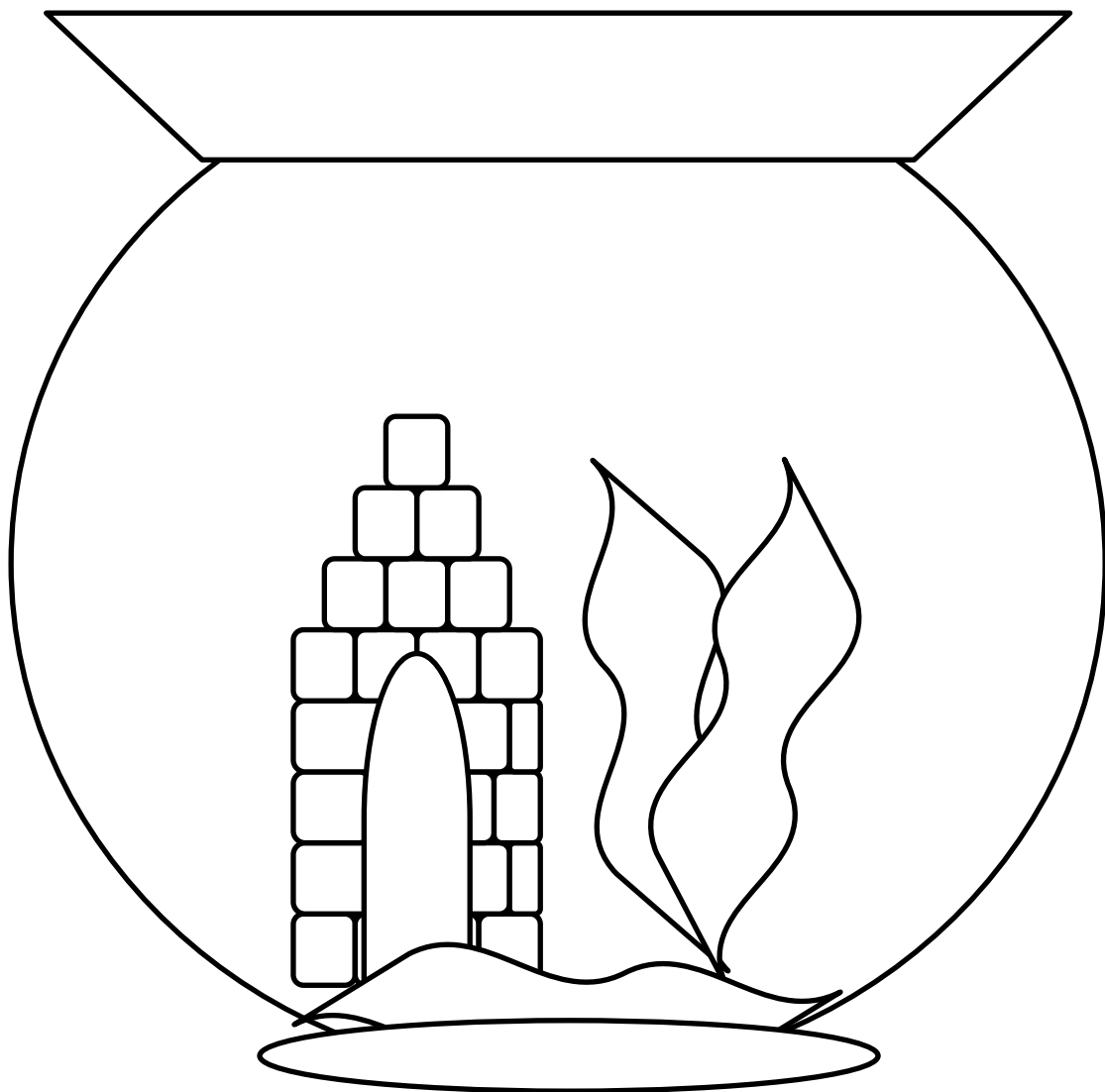

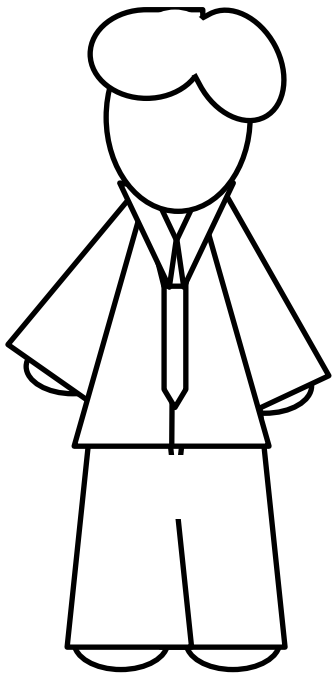
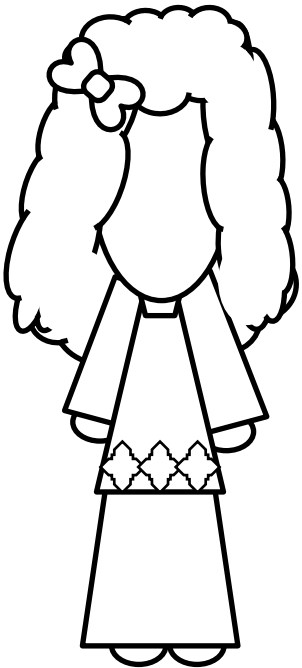

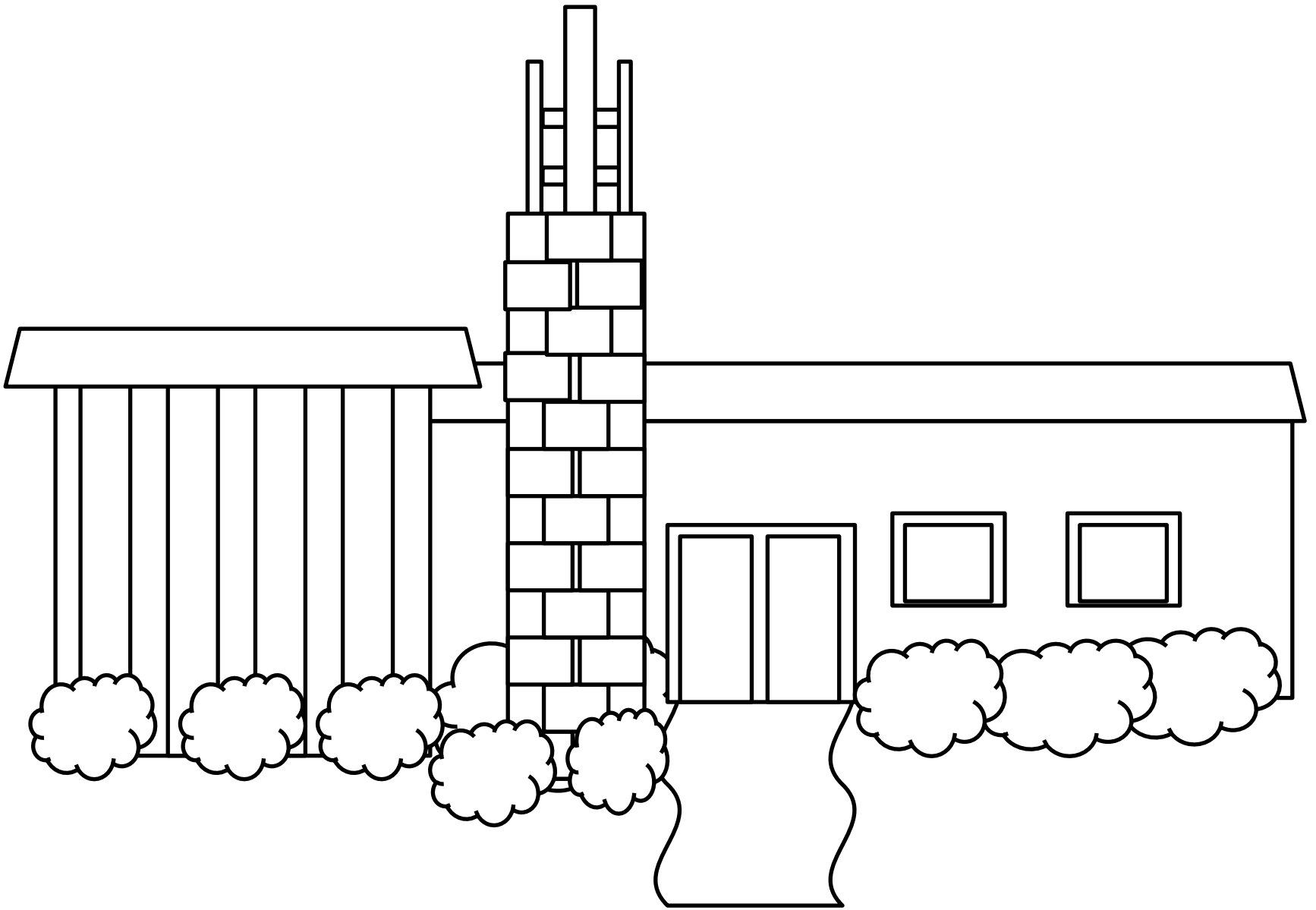

Instructions:

Primary manual 1 Lesson 42 “I Belong to the Church of Jesus Christ of Latter-day Saints

Page 2: Handout . You can copy and cut, then your children could place them where they belong

Page 3: Handout to color

Page 4-7: Copy and use for your lesson “where do these belong”

Page 8-11 Black and White

See Also:

Lesson 21 Primary Manual 2 B “We Receive Great Blessings as Members of Jesus Christ’s Church...”